

# SENIOR/CHAMP SPEEDSTAKES 1

## One Smart Dog UKI

Sunday April 12, 2026 Mark Upshaw

90 x 90 Indoors / Turf

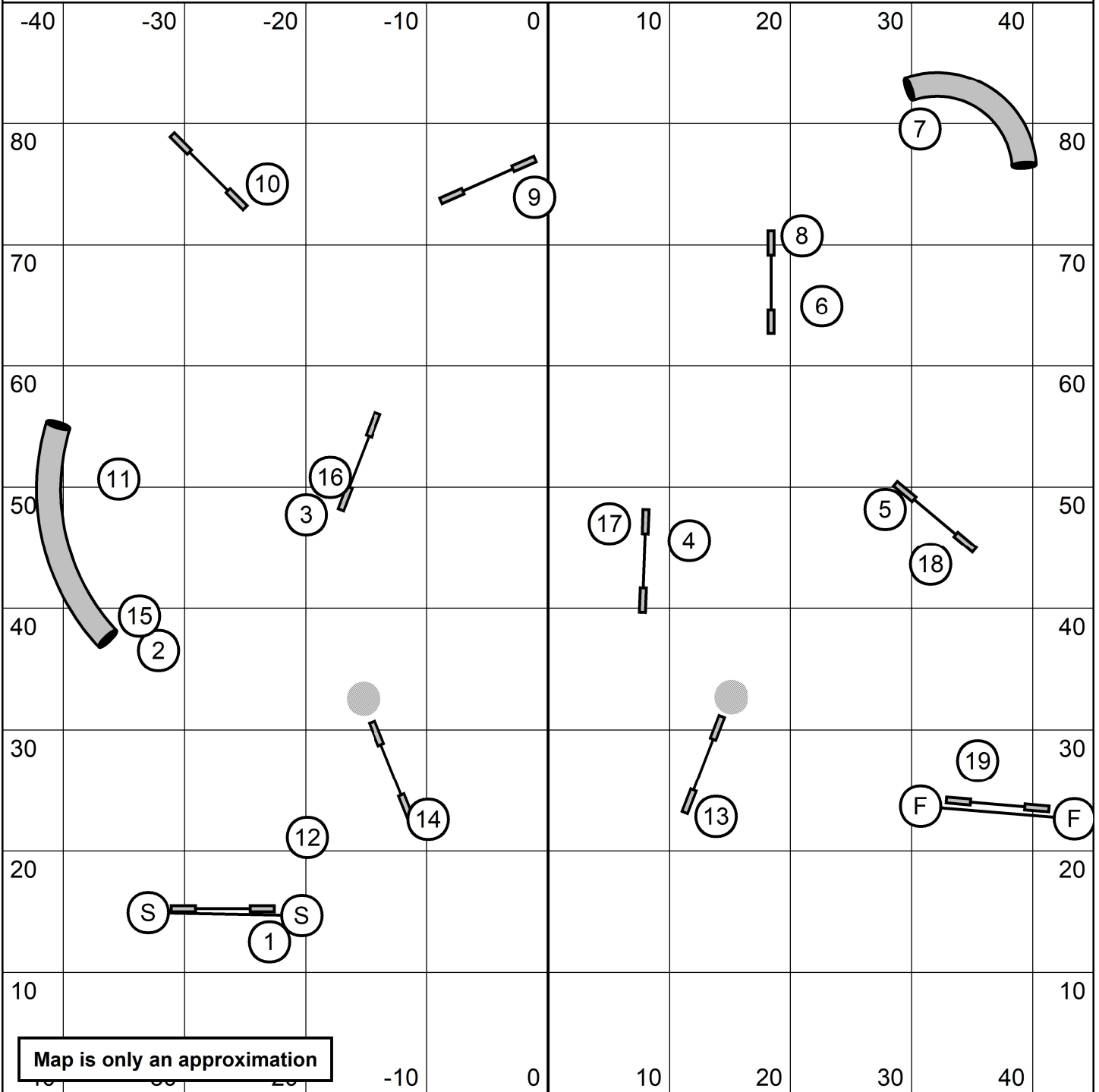

# BEGINNER/NOVICE SPEEDSTAKES 1

## One Smart Dog UKI

Sunday April 12, 2026 Mark Upshaw

90 x 90 Indoors / Turf

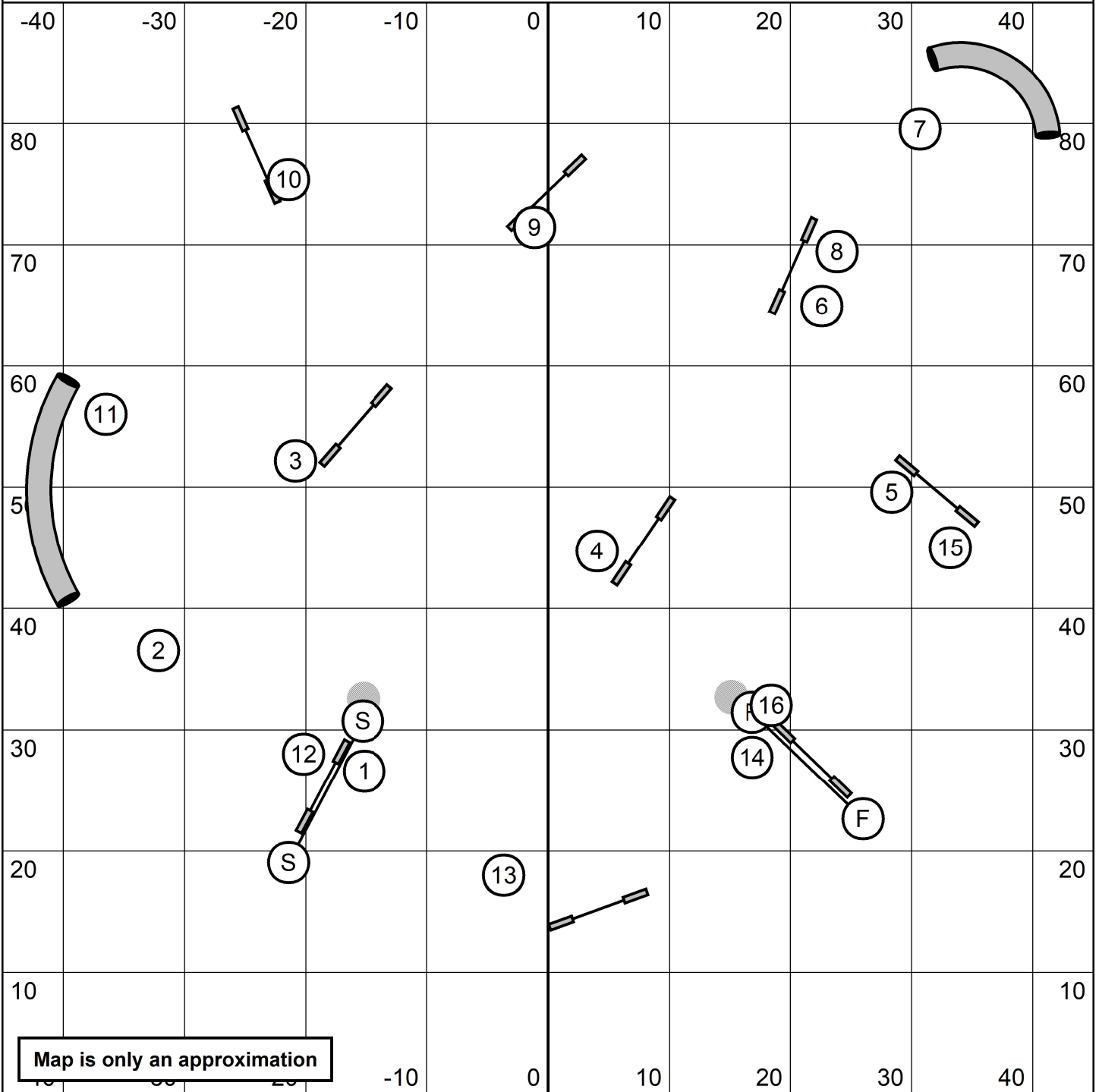

# SENIOR/CHAMP SPEEDSTAKES 2

## One Smart Dog UKI

Sunday April 12, 2026 Mark Upshaw

90 x 90 Indoors / Turf

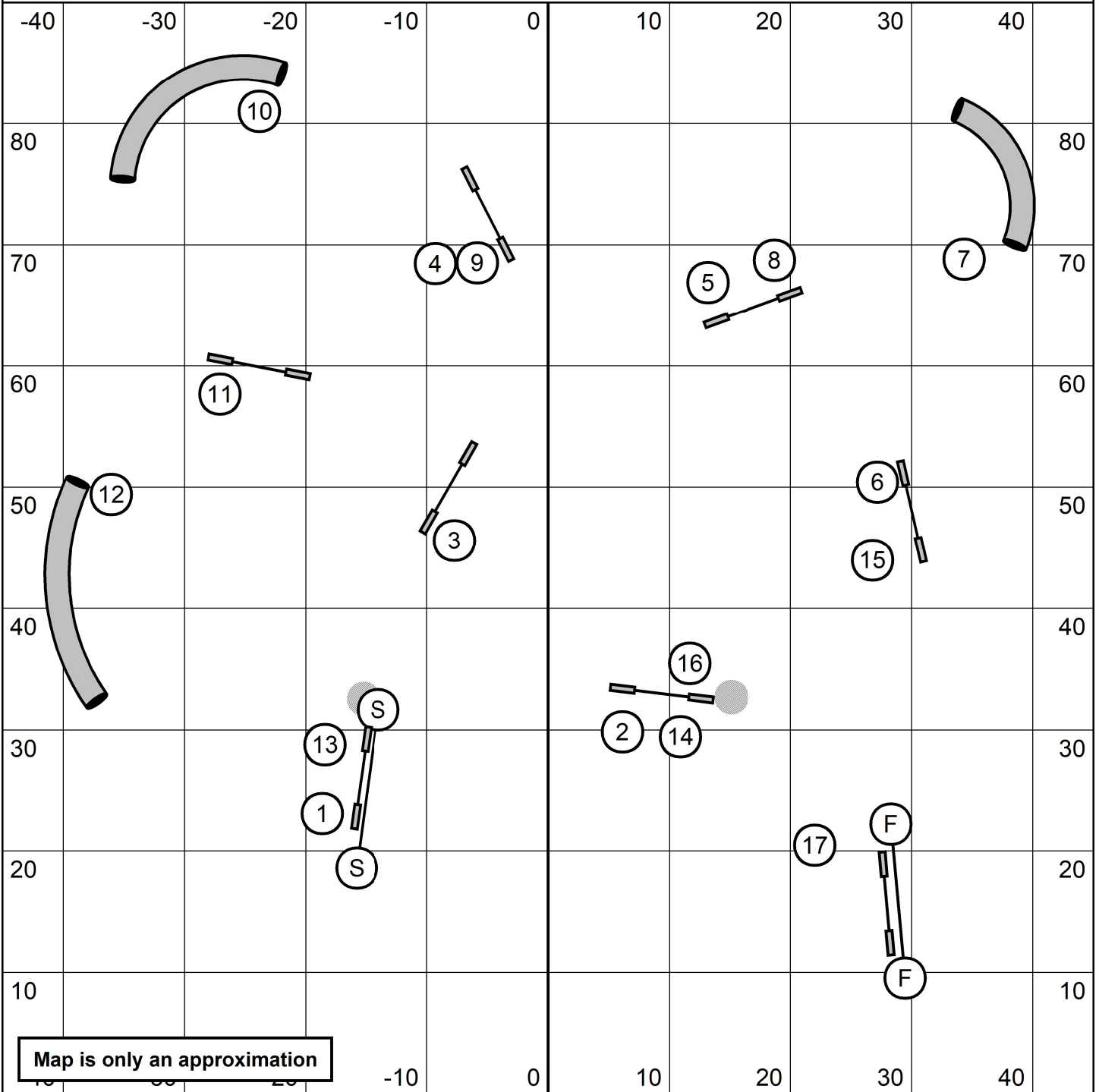

# BEGINNER/NOVICE SPEEDSTAKES 2

## One Smart Dog UKI

Sunday April 12, 2026

Mark Upshaw

90 x 90 Indoors / Turf

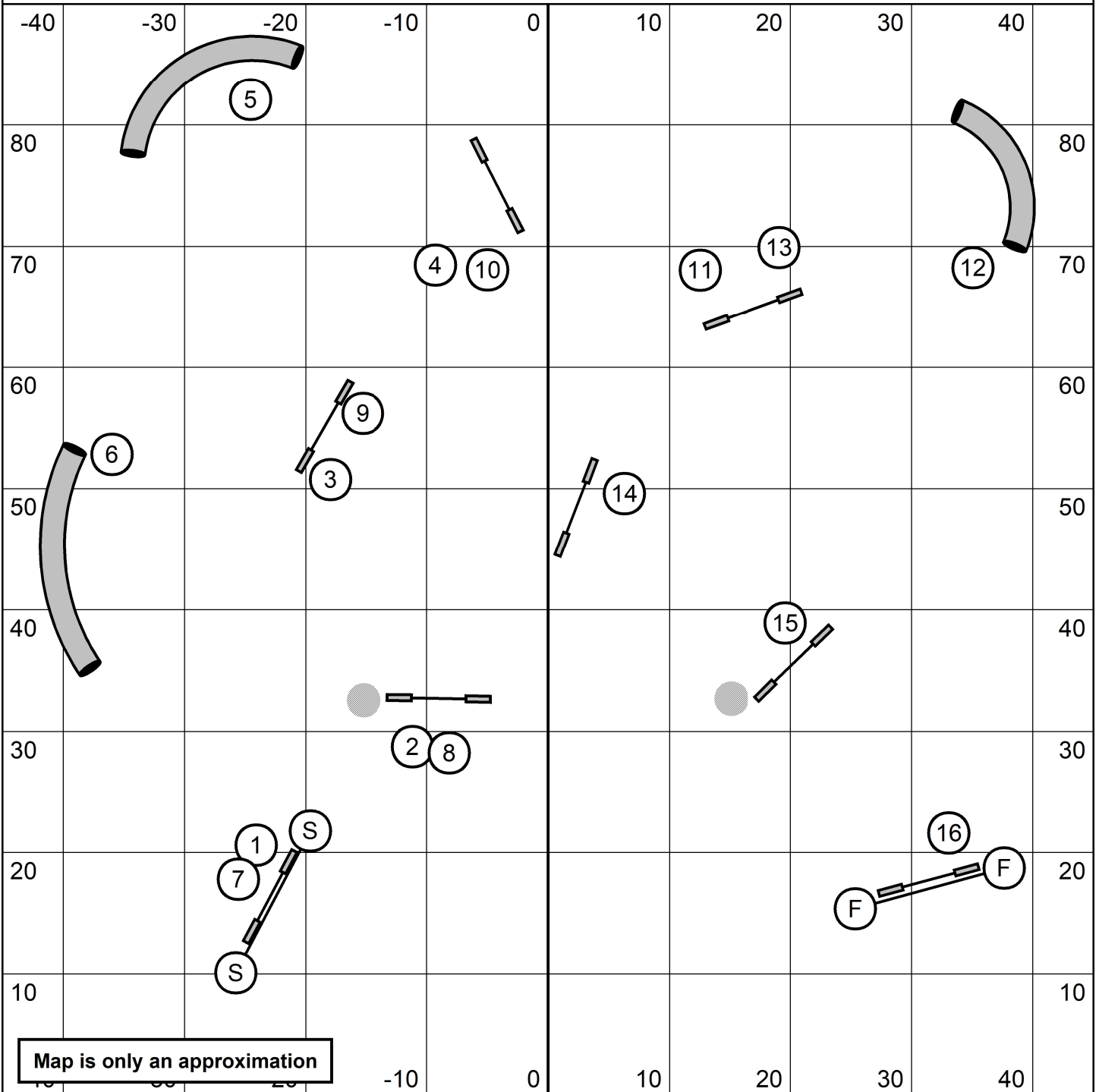

Map is only an approximation

# SENIOR/CHAMP JUMPING

## One Smart Dog UKI

Sunday April 12, 2026

Mark Upshaw

90 x 90 Indoors / Turf

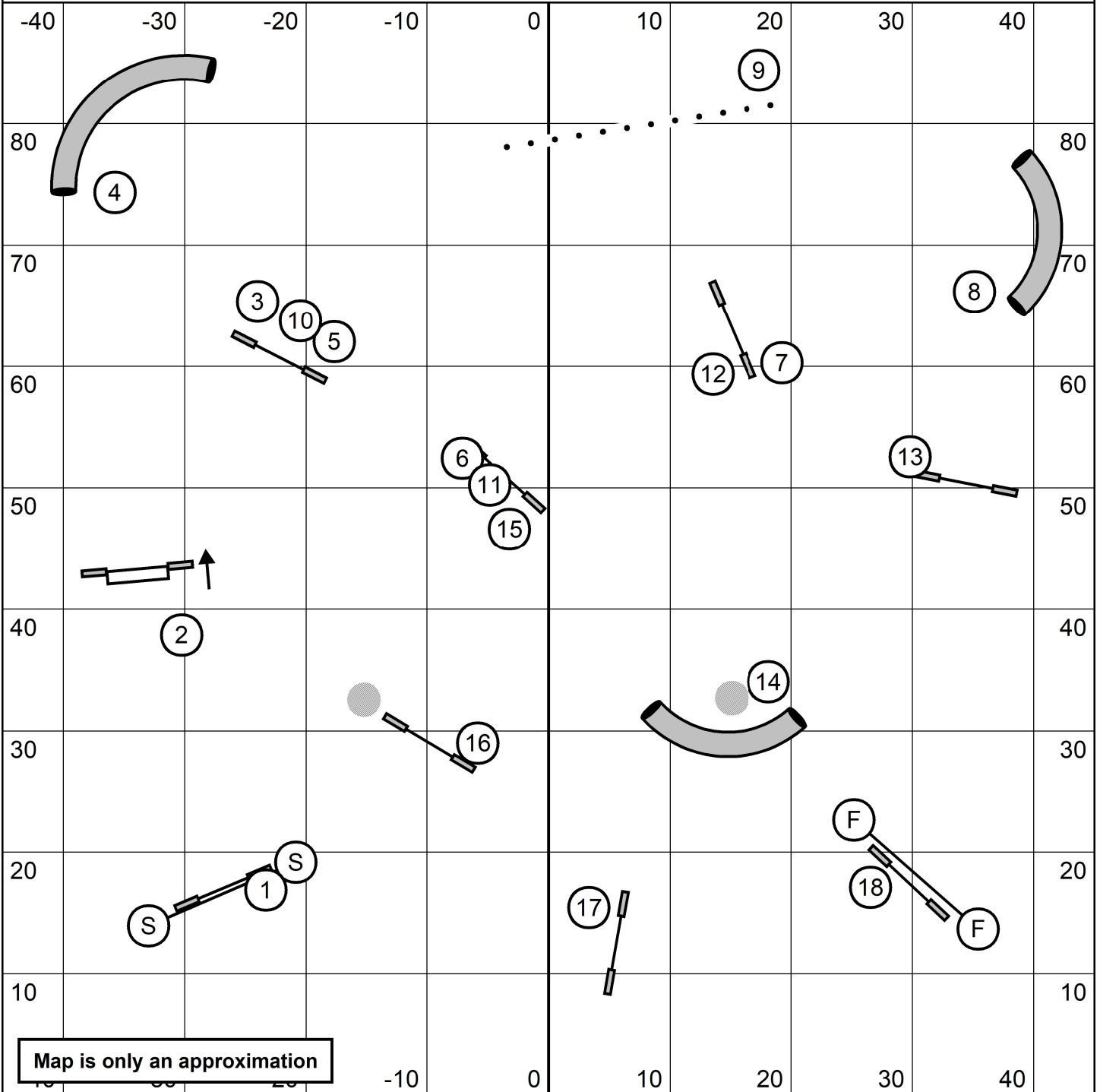

# BEGINNER/NOVICE JUMPING

## One Smart Dog UKI

Sunday April 12, 2026 Mark Upshaw

90 x 90 Indoors / Turf

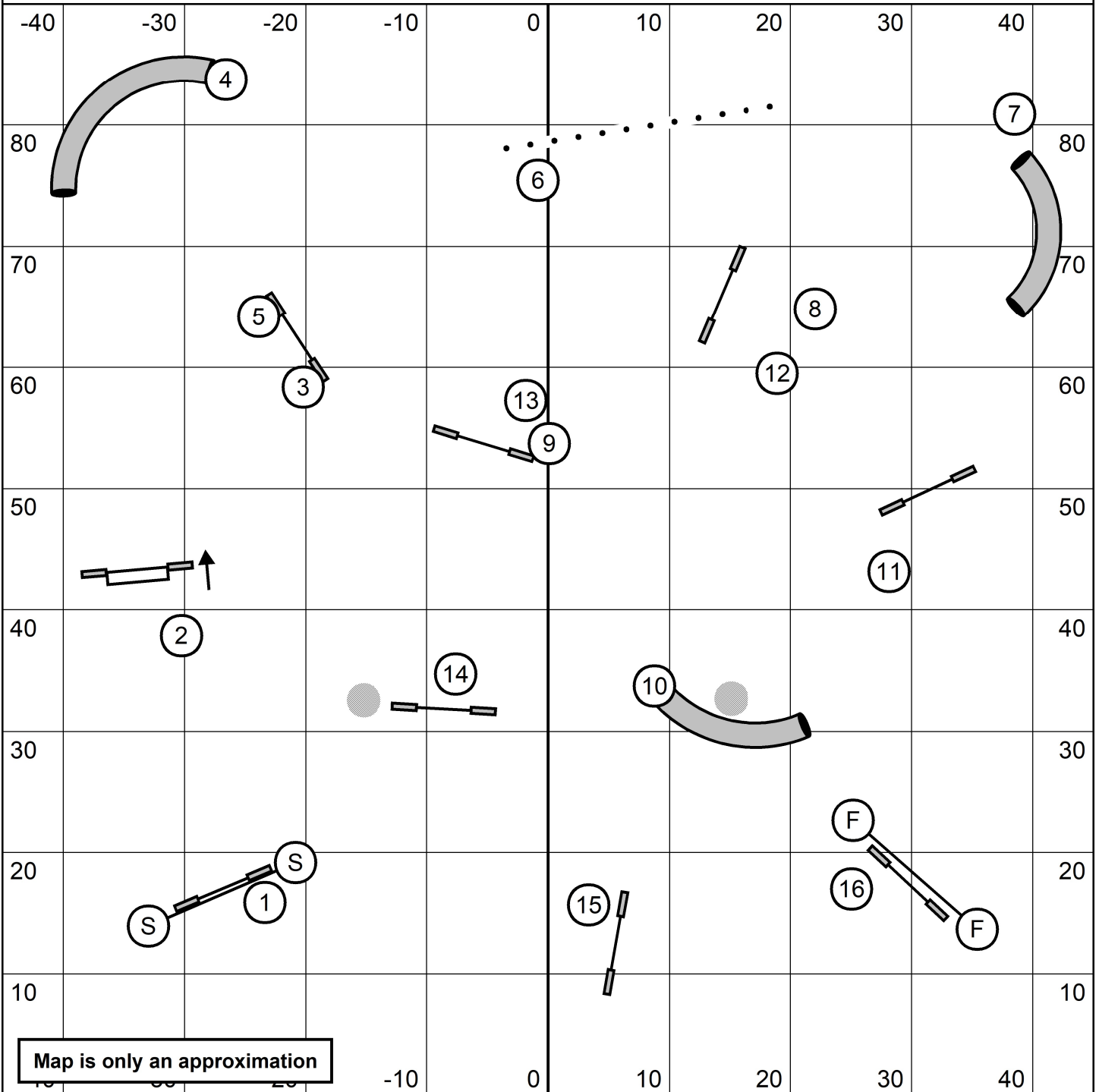

# COMBINED GAMBLERS

## One Smart Dog UKI

Sunday April 12, 2026 Mark Upshaw  
90 x 90 Indoors / Turf

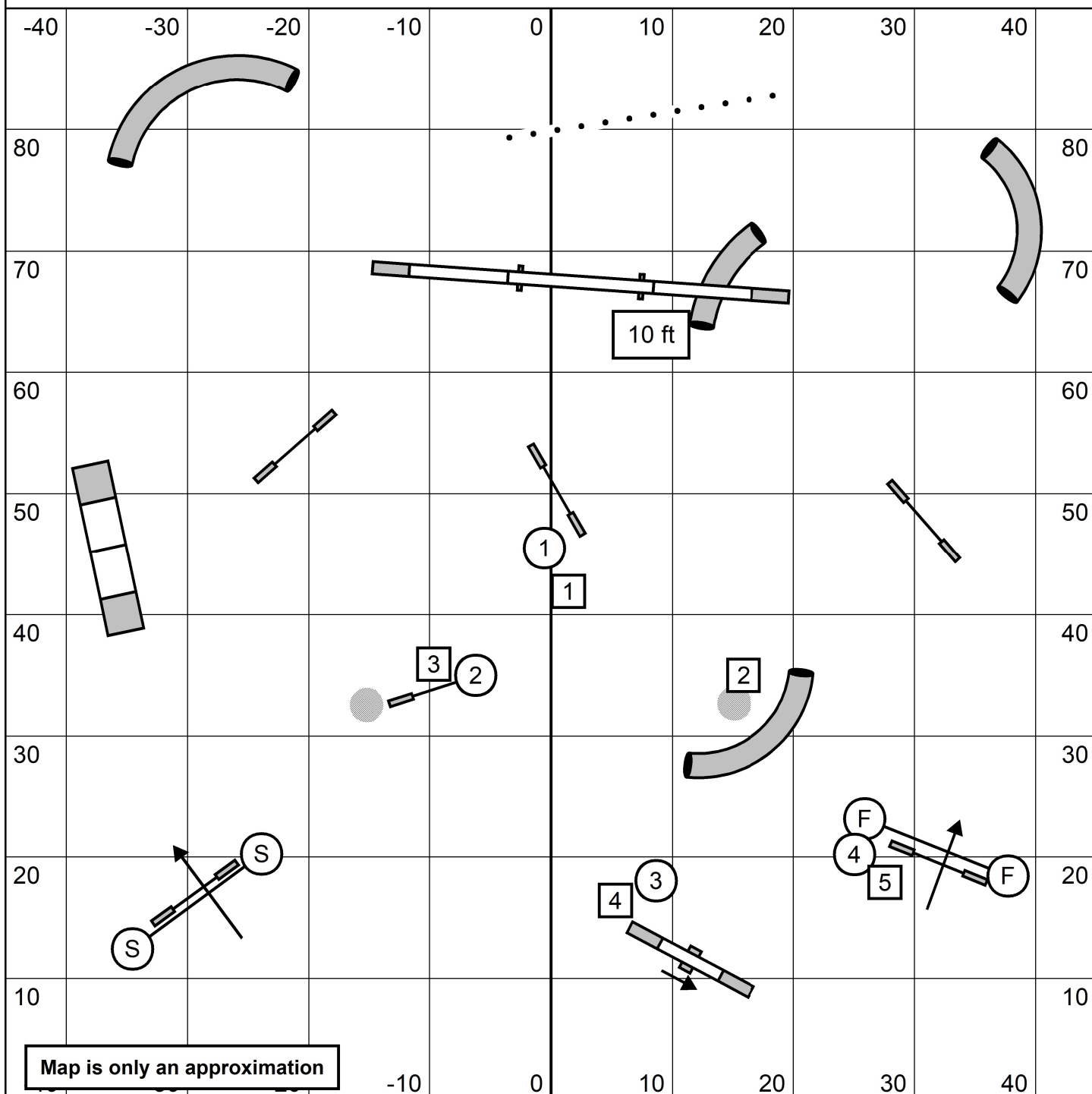

Map is only an approximation

Opening - 30 sec  
 Closing - 24/22/20 - 16 sec (Select - +2 sec)  
 16/12/8 - 19 sec (Select - +2 sec)  
 Gamble 1 - light circles - 10 points  
 Gamble 2 - light squares - 15 points

Start and Finish may only be taken once,  
 in direction indicated  
 Gamble obstacles MAY  
 be taken in order in opening  
 Back to back contacts allowed  
 No Refusals

# SENIOR/CHAMP AGILITY

## One Smart Dog UKI

Sunday April 12, 2026

Mark Upshaw

90 x 90 Indoors / Turf

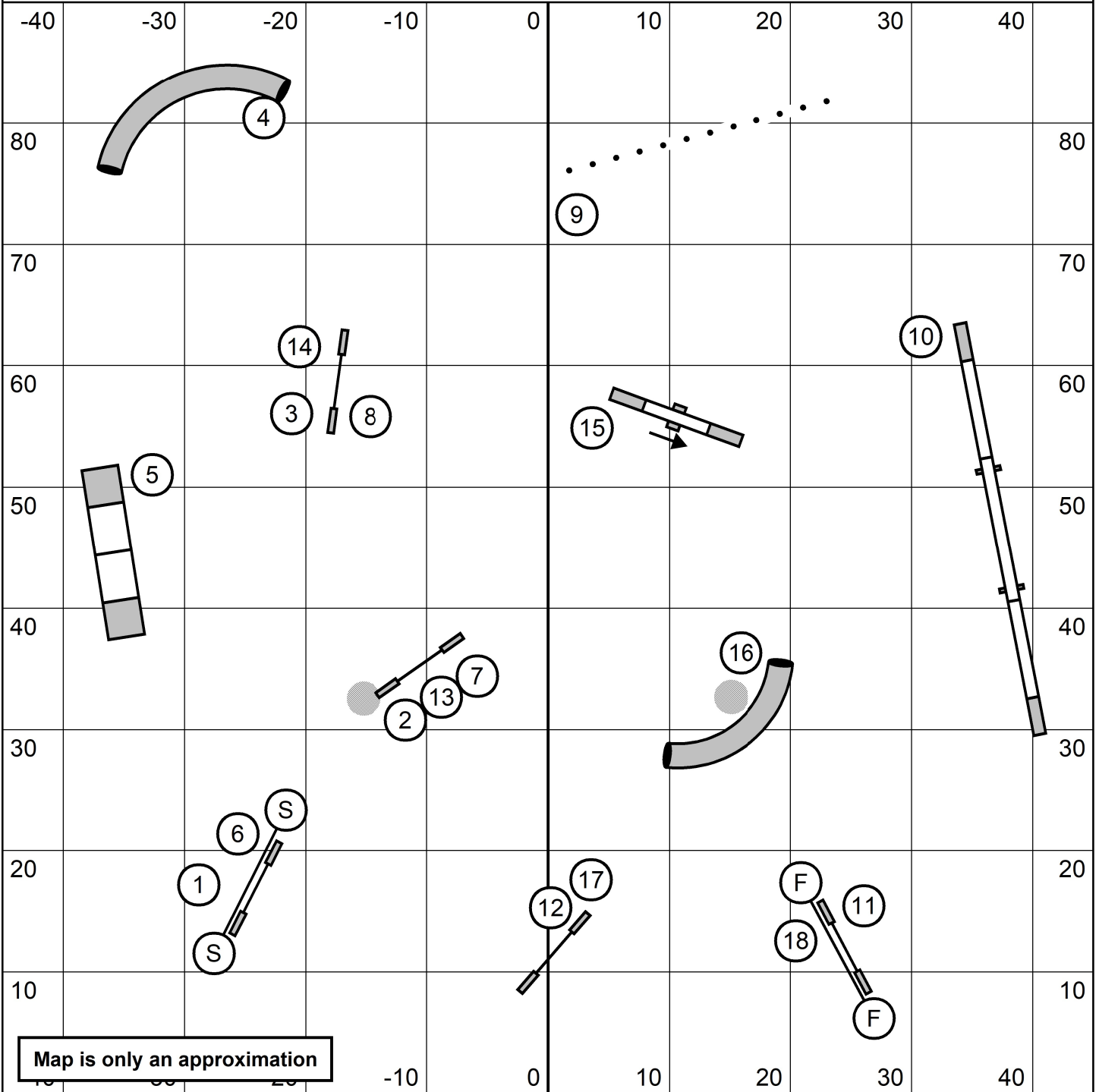

# BEGINNER/NOVICE AGILITY

## One Smart Dog UKI

Sunday April 12, 2026 Mark Upshaw

90 x 90 Indoors / Turf

